



July 11th, 2017

Ref.: Notice of Commencement of Construction
ECMS #74050: Ritner Highway Bridge
Route: 0011
Cumberland County, Pennsylvania

All,

This letter is notification that we are hereby commencing construction on the above referenced project on *July 29th, 2017*. A road closure with a detour will be set in place on the same specified date. If you have questions or concerns, please feel free to contact me at (717) 418-5650.

Thank you,

Scott J. Sanders

Scott Sanders
Vice President/Project Manager

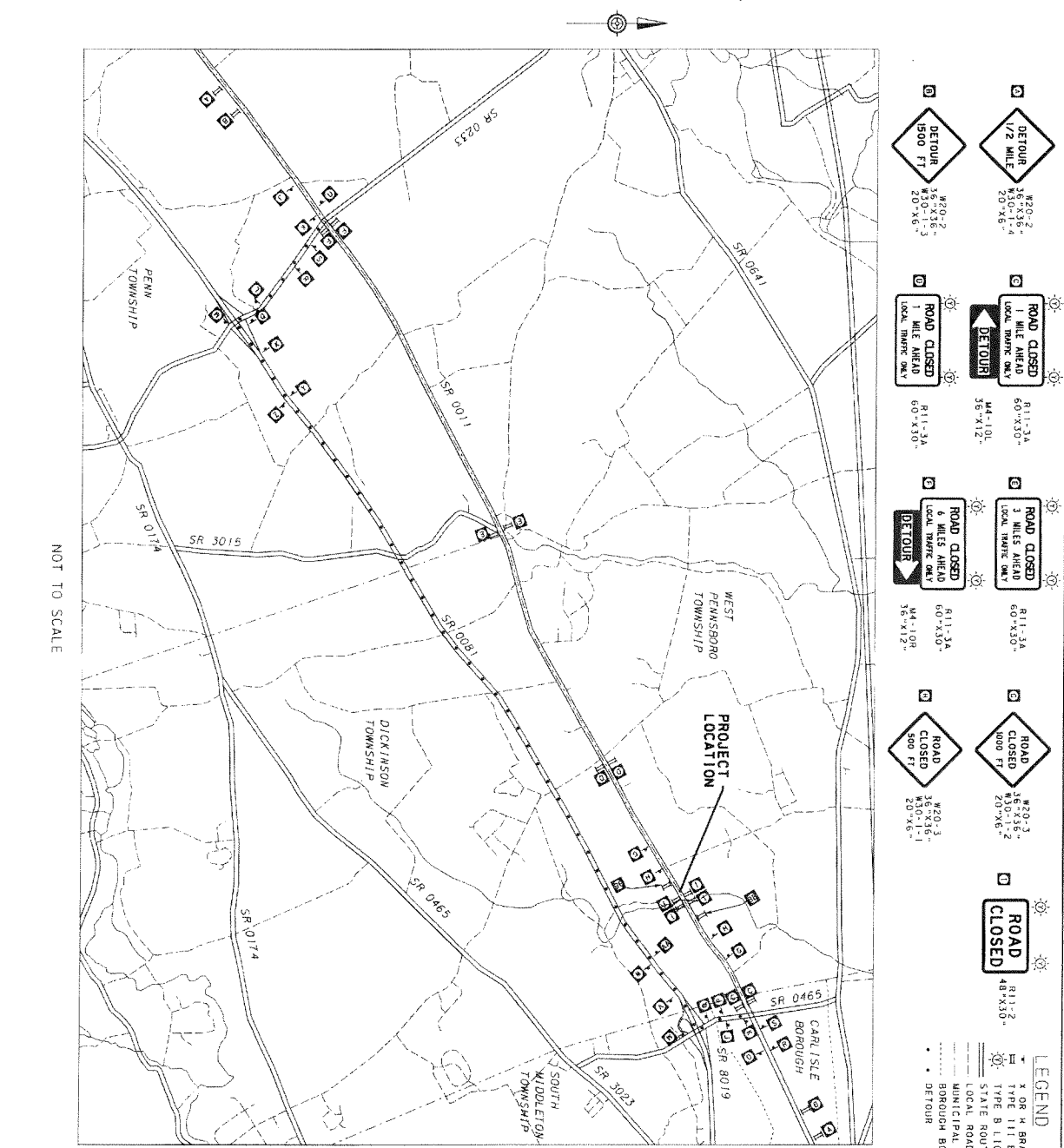

NOT TO SCALE

- DETOUR**
1/2 MILE
W20-2
35-X36-2
W30-1-4
20-X6-
- ROAD CLOSED**
1 MILE AHEAD
LOCAL TRAFFIC ONLY
M4-10U
35-X12-
- DETOUR**
1 MILE AHEAD
LOCAL TRAFFIC ONLY
M4-10U
35-X12-
- ROAD CLOSED**
3 MILES AHEAD
LOCAL TRAFFIC ONLY
R11-3A
60-X30-
60-X30-
- DETOUR**
6 MILES AHEAD
LOCAL TRAFFIC ONLY
R11-3A
60-X30-
M4-10R
35-X12-
- ROAD CLOSED**
1000 FT
W20-3
35-X36-2
W30-1-4
20-X6-
- ROAD CLOSED**
48-X30-

LEGEND
 X OR H BRACKET SIGN
 TYPE I II BARRICADE
 TYPE B LIGHT (YELLOW)
 STATE ROUTE
 LOCAL ROAD
 MUNICIPAL BOUNDARY
 BOROUGH BOUNDARY

DISTRICT	COUNTY	ROUTE	SECTION	SHEET
B-0	CUMBERLAND	0011	064	2 OF 3
WEST PENNSBORO TOWNSHIP				
DATE: 6/6/2016				
BY: [Signature]				
REVISIONS:				

SR 0011	SR 0011	SR 0011
DETOUR NORTH M4-8 24-X12- M3-1 24-X12- M1-4 24-X24- M5-1R 21-X15-	DETOUR SOUTH M4-8 24-X12- M3-3 24-X12- M1-4 24-X24- M5-15 21-X15-	DETOUR NORTH M4-8 30-X15- M3-1 30-X15- M1-4 36-X36- M5-2R 30-X18-
DETOUR NORTH M4-8 24-X12- M3-1 24-X12- M1-4 24-X24- M5-1 21-X15-	DETOUR SOUTH M4-8 24-X12- M3-3 24-X12- M1-4 24-X24- M5-15 21-X15-	DETOUR SOUTH M4-8 30-X15- M3-3 30-X15- M1-4 36-X36- M5-2R 30-X18-
DETOUR NORTH M4-8 24-X12- M3-1 24-X12- M1-4 24-X24- M5-1 21-X15-	DETOUR SOUTH M4-8 24-X12- M3-3 24-X12- M1-4 24-X24- M5-15 21-X15-	DETOUR SOUTH M4-8 30-X15- M3-3 30-X15- M1-4 36-X36- M5-2R 30-X18-
DETOUR NORTH M4-8 24-X12- M3-1 24-X12- M1-4 24-X24- M5-1 21-X15-	DETOUR SOUTH M4-8 24-X12- M3-3 24-X12- M1-4 24-X24- M5-15 21-X15-	DETOUR SOUTH M4-8 30-X15- M3-3 30-X15- M1-4 36-X36- M5-2R 30-X18-
DETOUR NORTH M4-8 24-X12- M3-1 24-X12- M1-4 24-X24- M5-1 21-X15-	DETOUR SOUTH M4-8 24-X12- M3-3 24-X12- M1-4 24-X24- M5-15 21-X15-	DETOUR SOUTH M4-8 30-X15- M3-3 30-X15- M1-4 36-X36- M5-2R 30-X18-
DETOUR NORTH M4-8 24-X12- M3-1 24-X12- M1-4 24-X24- M5-1 21-X15-	DETOUR SOUTH M4-8 24-X12- M3-3 24-X12- M1-4 24-X24- M5-15 21-X15-	DETOUR SOUTH M4-8 30-X15- M3-3 30-X15- M1-4 36-X36- M5-2R 30-X18-
DETOUR NORTH M4-8 24-X12- M3-1 24-X12- M1-4 24-X24- M5-1 21-X15-	DETOUR SOUTH M4-8 24-X12- M3-3 24-X12- M1-4 24-X24- M5-15 21-X15-	DETOUR SOUTH M4-8 30-X15- M3-3 30-X15- M1-4 36-X36- M5-2R 30-X18-
DETOUR NORTH M4-8 24-X12- M3-1 24-X12- M1-4 24-X24- M5-1 21-X15-	DETOUR SOUTH M4-8 24-X12- M3-3 24-X12- M1-4 24-X24- M5-15 21-X15-	DETOUR SOUTH M4-8 30-X15- M3-3 30-X15- M1-4 36-X36- M5-2R 30-X18-

SR 0011
DETOUR PLAN

THIS BRIDGE TO BE CLOSED FOR CONSTRUCTION XX-XX-XXXX

#23-101
 96-X48
 LATE DATE

